

# HYPHERPRO

## STEERING DAMPER MOUNTING KIT

for

### HONDA CBR1000RR Model 2004 - 2007

#### MK-HO10-T004 PART LIST

SD stroke 75	1	Electrical connector	1
Tube Clamp TYPE 1	1	-	-
O-Ring	2	-	-
CNC Fork Bracket	1	-	-
CNC Tank Bracket	1	-	-
M6x35	2	-	-
M8x25 Button head	2	-	-
Washer M8 $\phi$ 16	3	-	-

ALL IDEAS, DESIGNS ARRANGEMENTS AND PLANS INDICATED OR REPRESENTED BY THIS DRAWING ARE OWNED BY HYPERPRO AND WERE CREATED, EVOLVED AND DEVELOPED FOR USE ON AND IN CONNECTION WITH THE SPECIFIC PROJECT. NONE SUCH IDEAS, DESIGNS, ARRANGEMENTS OR PLANS SHALL BE USED BY OR DISCLOSED TO ANY PERSON, FIRM OR CORPORATION FOR ANY PURPOSE WHATSOEVER WITHOUT THE WRITTEN PERMISSION OF HYPERPRO.

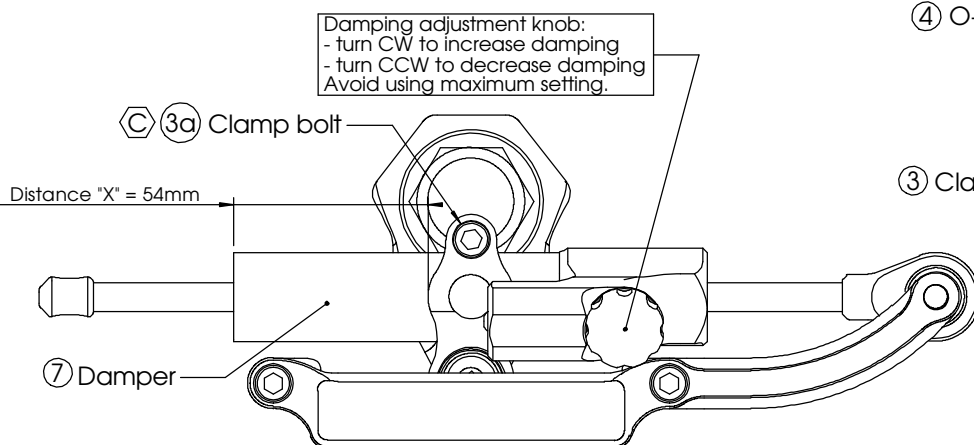

**! Before installation, remove the original steering damper:**

- remove all tank plastics
- disconnect and remove the original damper
- install Hyperpro electrical connector
- install Hyperpro steering damper kit
- reinstall tank plastics

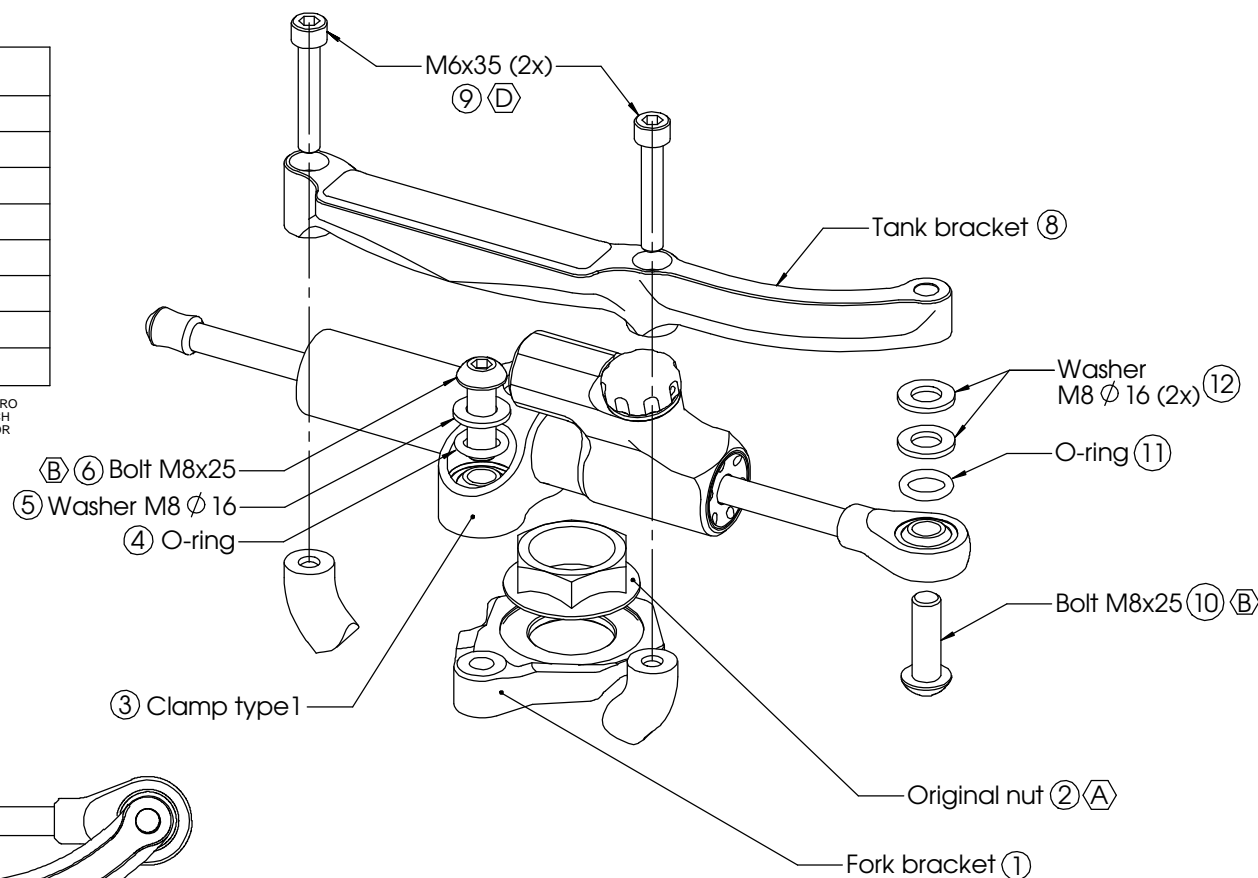

1  
of 2

(A) 55-75Nm / 486-663Lbs.In / 40-55Lbs.Ft	(C) 6Nm / 53Lbs.In / 4.4Lbs.Ft
(B) 14-17Nm / 124-150Lbs.In / 10.3-12.5Lbs.Ft	(D)

See [WWW.HYPERPRO.COM](http://WWW.HYPERPRO.COM) for the latest pictures, modifications, specs. and e-drawings of this steering damper kit.

# HYPERPRO

## STEERING DAMPER MOUNTING KIT

for

### HONDA CBR1000RR Model 2004 - 2007

#### MK-HO10-T004 INSTALLATION INSTRUCTIONS

#### In general:

HYPERPRO can not be held responsible in any way for any form of physical, material, financial or other damage arising from use, assembly or overhaul of HYPERPRO products. HYPERPRO reserves the right to make changes without prior notice.

This product is ONLY TO BE INSTALLED BY A PROFESSIONAL MECHANIC.

This product is only to be used for the motorcycle brand, model and year stated specifically on top of the pages of this manual.

DO NOT attempt to install this product on motorcycles from any different brand, model and/or year than stated on the pages of this manual.

DO NOT use this kit for cars, boats, jet-skies, snowmobiles, ATV's, aircraft, hovercrafts or any other vehicle and/or purpose.

HYPERPRO steering dampers are FOR RACE USE ONLY, NOT FOR HIGHWAY USE!

#### Before installation:

- Please read the entire manual carefully before starting the installation!
- Check if you have all the tools required. Good tools are a must.
- Protect your bike at the most important places in and around the work area (e.g. tank, fairing, frame, etc.) with a blanket, towel or similar.

#### During installation:

- Check all operations and parts carefully before, during and after performing each step.
- Clean all surfaces that are required for fitting parts together or for applying self adhesives or loctite, thoroughly with contact cleaner or another degreaser, unless otherwise stated.
- Be careful not to damage or scratch any part of your bike.
- ALWAYS work relaxed and concentrated!! It is very easy to damage something or make a mistake.

#### After installation:

- Check and make sure that there is no contact between any part of the steering damper kit and any part of the motorcycle. The kit should not hit anything. Steering movement should not be limited by the steering damper. If the steering movement is limited, adjust the position of the tube in the clamp until steering movement is normal again. Do not forget to tighten the clamp bolt again!
- ALWAYS check the steering movement and feeling before each ride!
- FIRST RIDES: Start with the damper turned fully open (turn adjuster knob fully counter clockwise). Start adjusting in between rides with steps of MAX. 2 CLICKS (0.25 TURN) EACH TIME, until the damper is working satisfactory for your riding style.
- NEVER USE MAXIMUM SETTING, ALWAYS OPEN AT LEAST 2 CLICKS (0.25 TURN).

- WARNING ! DAMPER HAS AN ACTIVE / SPEEDSENSITIVE DAMPING SYSTEM;
  - Steering with NORMAL MOVEMENT should be FREE !!
  - Steering with FAST MOVEMENT should be CONTROLLED BY DAMPER !!
- HYPERPRO uses a special seal to reduce friction. The seal uses an oil film to work properly. It is normal that some oil can appear on the pistonrod.
- Damper works with oil: DAMPING CAN BE HARDER AT LOWER TEMPERATURES!

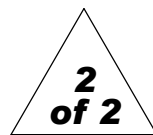

#### Step 1: remove the original steering damper

- Remove the tank plastics to get access to all the mounting points.
- Remove the original steering damper and all of its components, disconnect the power supply.

The Hyperpro steering damper kit can be fitted with all bodywork fitted, but we advise to refit the tank plastics AFTER installation of the Hyperpro steering damper to lower the chances of scratches to the tank.

#### Step 2: install Hyperpro electrical connector

Install the Hyperpro connector to replace the original steering damper. It will prevent the HESD warning light to go on.

#### Step 3: installing the fork bracket

- Fork bracket (1)

Loosen and remove the steering stem nut (2), using a 30mm key. Place the bracket (1) over the thread, between the two notches on the triple clamp. Replace the nut on top of the fork bracket and tighten carefully with a torque of approx. 55-75Nm/486-663Lbs.In/40-55Lbs.Ft.

#### Step 4: installing the damper clamp

- Damper tube clamp Type 1 (3)
- 1x O-Ring (4)
- Washer M8  $\varnothing$  16 (5)
- Bolt M8x25 button head (6)

Put the parts together as shown on page 1: place the clamp (3) on top of the fork bracket (1) and use the O-ring (4), washer (5) and bolt (6) to screw them together. Tighten the bolt with a torque of approx. 14-17Nm/124-150Lbs.In/10.3-12.5Lbs.Ft.

#### Step 5: installing the steering damper

- Steering damper (7)

Ensure that the clamp bolt of the Tube clamp is pointing forward. Shove the damper (7), with the end knob-side first, through the clamp until the distance "X" (=54mm) stated on page 1 is reached. Make sure that the gas reservoir is straight above the main tube. Then tighten the M6 clamp bolt (3a) with a torque of approx. 6Nm/53Lbs.In/4.4Lbs.Ft.

#### Step 6: installing the tank bracket

- Tank bracket (8)
- 2x Bolt M6x35 (9)
- Bolt M8x25 button head (10)
- 1x O-ring (11)
- 2x Washer M8  $\varnothing$  16 (12)

Install the tank bracket (8) on the upper two original mounting points, using the 2 supplied M6x35 bolts (9). Tighten the bolts with a torque of approx. 5-9Nm/44-80Lbs.In/4.0-6.4Lbs.Ft. Use the M8-bolt (10), O-ring (11) and washers (12) to fit the damper head to the tank bracket. Tighten the bolt with a torque of approx. 14-17Nm/124-150Lbs.In/10.3-12.5Lbs.Ft.

Check if the damper is level horizontally and aligned to the bike. Check if the damper does not touch anything (e.g. tank) when steering from left to right. Check if the bike can make it's full steering angle from left to right and adjust if necessary.

**See [WWW.HYPERPRO.COM](http://WWW.HYPERPRO.COM) for the latest pictures, modifications, specs. and e-drawings of this steering damper kit.**