

CAUTION

- Before use of this tool, please check whether this tool is suitable for your selected chain and/or size of connecting link.
- When press fitting and/or riveting, be sure to check that connecting link is the same size and type as those of the chain to be connected.
- Be sure to put on safety goggles when working.

Structure & Each Part

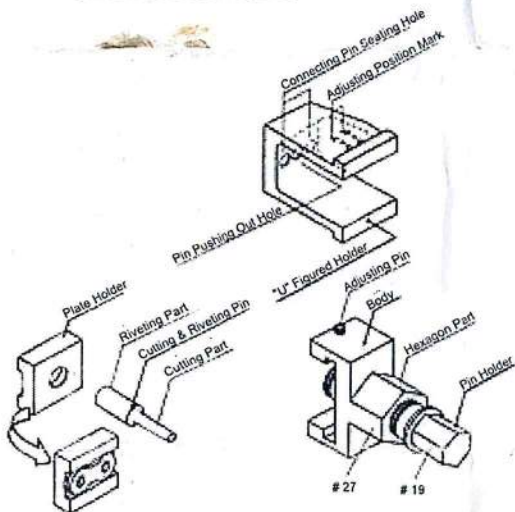

Chain and Connecting Link

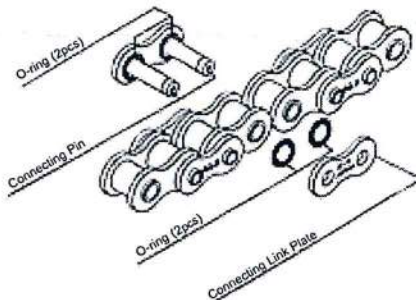

Tools necessary to work
 • Closed Wrench (#27)...
 Holding hexagon part of body
 • Closed Wrench (#19)...
 Holding pin holder

1. Disassembling of Chain (Pushing out of Pin)

- (1) Set "U figured holder" ("U" holder) with a chain link to be disconnected.
- (2) A cutting & riveting pin is set into a pin holder as shown in the right Fig, and turn a pin holder so as not to make pin head projected from a body so much.
- (3) A body is set on "U holder" holding a chain, and adjusting pin is adjusted on mark A of "U" holder.
- (4) Turn a pin holder by hand until that a cutting & riveting pin contacts with a pin of the chain. Be sure to check cutting pin is contacted in center with a pin of chain.
- (5) Hold hexagon part of a body by a closed wrench (#27) and push out the chain-pin from the link plate by turning a pin holder clockwise with a closed wrench (#19).

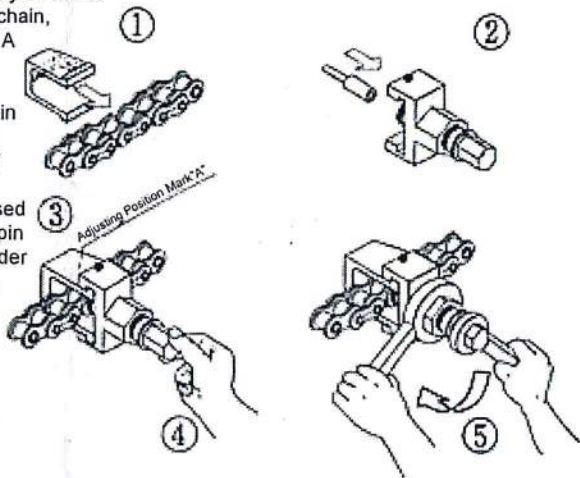

2. Press Fitting of Connecting Link Plate

- (1) Connect both ends of a chain with connecting link, and press a connecting plate into connecting pins by hand.
 * Be use to check that grease is put on connecting pins.
 * For O-ring chain, be sure to check that 4pcs of O-ring are set into the proper position.
- (2) Set pin heads of connecting link into pin-holes of "U" holder.
- (3) Fit a plate holder and a cutting & riveting pin on a body as shown in the right Fig.
- (4) Set a body on "U" holder holding a chain, and adjust "U" holder so that a adjusting pin is set into the mark "A" of "U" holder.
- (5) Turn a pin holder by hand until that a plate holder contacts with the connecting link plate.
- (6) Holding hexagon part of a body by closed wrench (#27), and turn a pin holder by a closed wrench (#19) clockwise until that connecting pins contact with a plate holder as shown in above Fig.

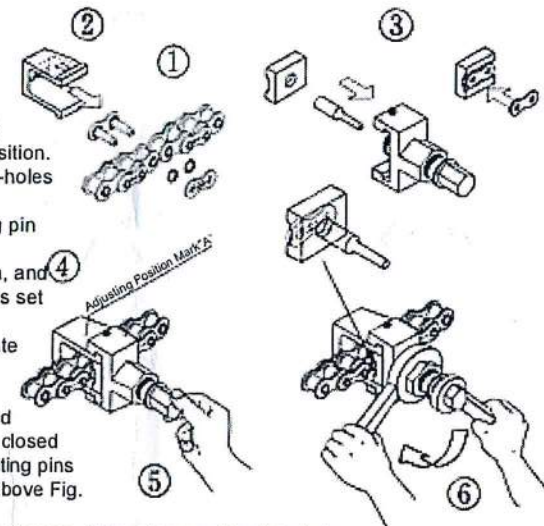

* Disassemble a plate holder after complete of press-fitting of connecting link plate.
 * Be sure to make riveting work given below after press-fit work.

3. Riveting of pin

- (1) A connected link by above work is set with "U" holder as shown in the right Fig.
- (2) Set a cutting & riveting pin into a pin holder as shown in the right Fig.
- (3) Set a body with "U" holder holding a chain, and adjust an adjusting pin in the mark "B" of "U" holder.
- (4) Turn a pin holder by hand until that a cutting & riveting pin contacts with a connecting pin (a).
- (5) Holding the hexagon part of a body by a closed wrench (#27), turn a pin holder by a closed wrench (#19) clockwise until that flared part of riveting pin head contacts with surface of a connecting link plate.
- (6) In order to rivet a connecting pin (b), return a pin holder, and move a chain in one pitch. Then, repeat to work as above (1)-(5).

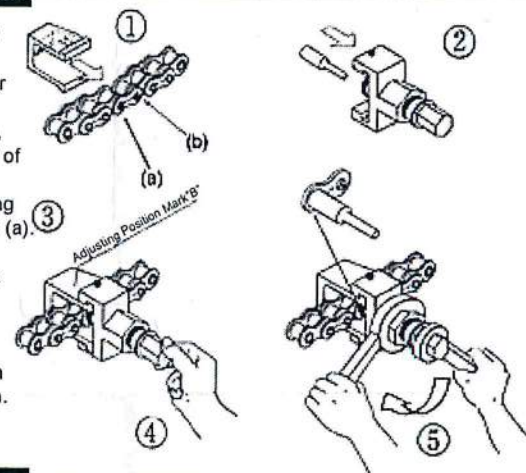

4. Condition of Riveted Pin

Be sure to check that out side round of both riveted pins are the same Fig "OK"

